

COURSES down Penns Creek.

- N. 22. E. -- 12. --
- N. 35 E. -- 17. 7.
- N. 39 E. -- 16. 0.
- N. 55 E. -- 12. 5.
- N. 73 E. -- 8. 3.
- East ---- 13. --
- S. 50 E. -- 72. --
- S. 45 E. -- 16. --
- 167.5.

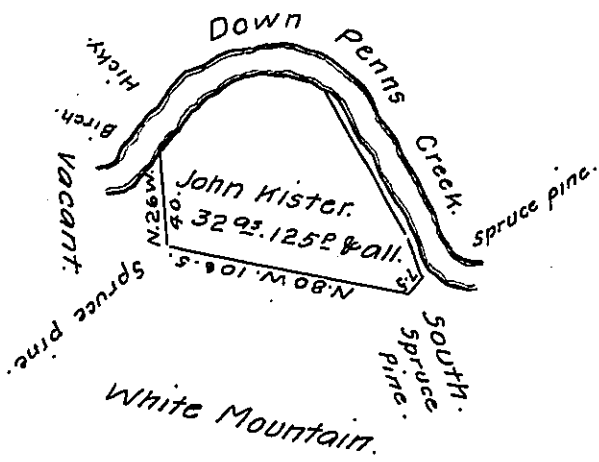

A Draught of a tract of land called --- situate in Hartley township Union County containing thirty two Acres and one hundred and twenty five perches and the usual Allowance of Six per Cent. for roads &c. Surveyed the Ninth day of September A.D. One thousand eight hundred and fourteen for John Kister in pursuance of his Warrant bearing date the seventeenth day of August A.D. One thousand eight hundred and fourteen.

To Richard T. Leech, Esquire,  
Surveyor General of Pennsylv<sup>a</sup>.

Simon Snyder, Jun<sup>r</sup>, D.S.

IN TESTIMONY that the above is a copy of the original remaining on file in the Department of Internal Affairs of Pennsylvania, made conformably to an Act of Assembly approved the 16th day of February, 1833, I have hereunto set my Hand and caused the Seal of said Department to be affixed at Harrisburg, this twenty eighth day of February, 1908.

*Henry Howch*  
Secretary of Internal Affairs.